

SITE PLAN		CITY, STATE — STREET VALE, LINCOLN COUNTY, NC — HALLMAN MILL RD		PARCEL ID: 2664787952, 2664891505, 2664892457	
PROTOTYPE:	D	DEVELOPER	DESIGNER	DATE	
BLDG SF:	10,640/8,504 SF	COMPANY:	TERAMORE DEVELOPMENT, LLC	COMPANY:	TERAMORE DEVELOPMENT, LLC
ACREAGE:	1.9 ± AC	NAME:	JOSH HUFSTETLER	NAME:	CHAD STRICKLAND
PARKING:	36	PHONE:	(229) 977-3931	PHONE:	(229) 977-1008

IMPERVIOUS SURFACE: 40,005 SQ FT — 47%

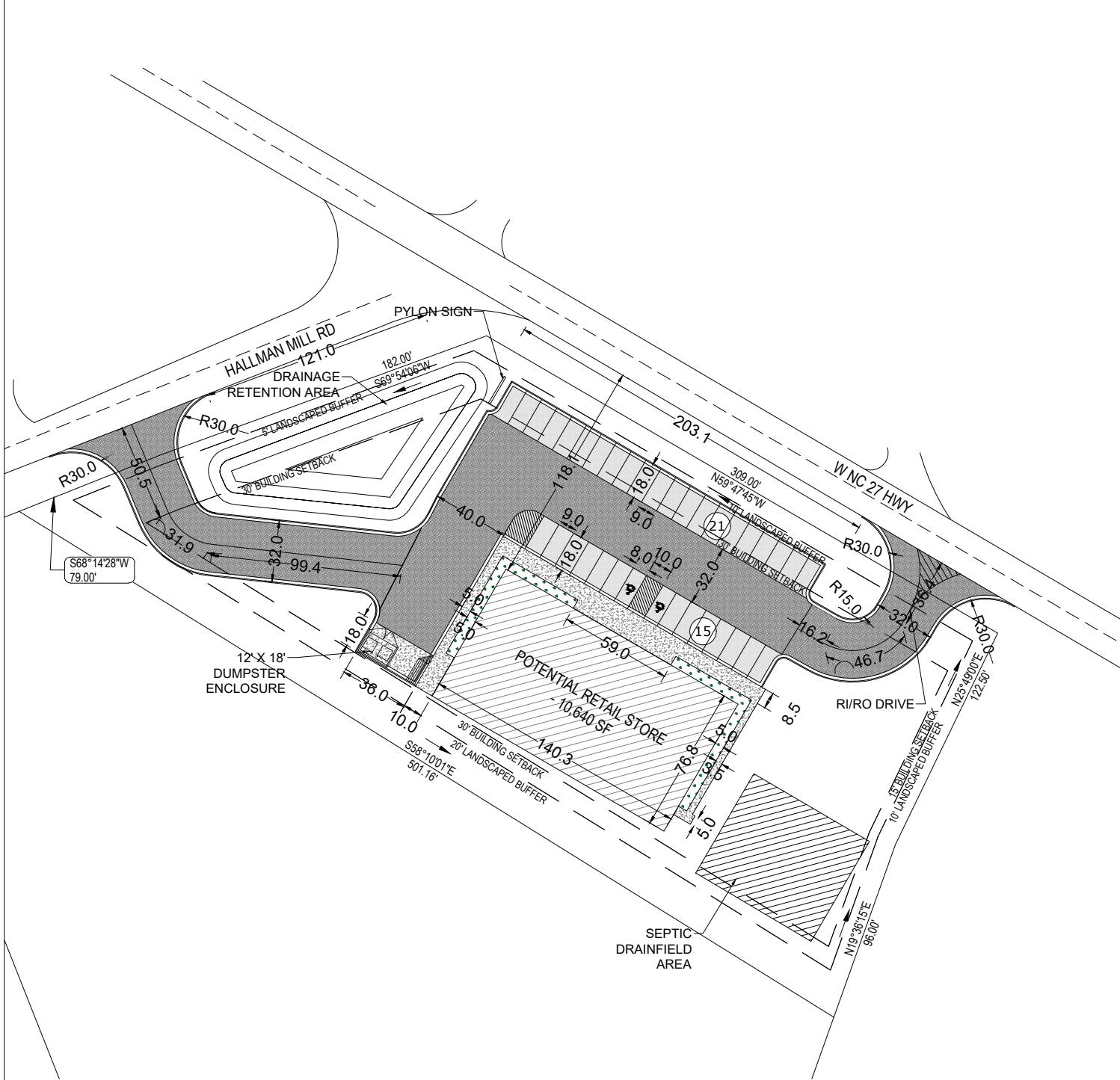

LEGEND	
	EXISTING ASPHALT
	PROPOSED HD ASPHALT
	PROPOSED CONCRETE
	PROPOSED LD ASPHALT
	PROPOSED LANDSCAPING

**GENERAL NOTES:**

1. PRELIMINARY BOUNDARY IS BASED ON INFORMATION FROM PROPERTY APPRAISER AND SHALL BE USED FOR ILLUSTRATIVE PURPOSES ONLY. THIS PLAN SHALL NOT BE INTENDED TO CERTIFY THE ACCURACY OF EXISTING SURFACE OR SUBSURFACE CONDITIONS. ALL AREAS AND DIMENSIONS ARE APPROXIMATE AND SHOULD BE VERIFIED BY ACTUAL SURVEY.

2. PROPOSED ACCESS LOCATIONS SHALL BE APPROVED BY REGULATORY AGENCIES HAVING JURISDICTION.

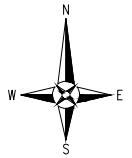

SCALE: 1" = 75'  
(ON 8.5" X 11")